



Fingerprint bicycle lock

Your finger is the key

- 360° fingerprint recognition
- Supports 20 fingerprints
- Additional connections and APPs are not necessary

ZR 307 Fingerprint bicycle lock

120 x 370 mm

Operating manual

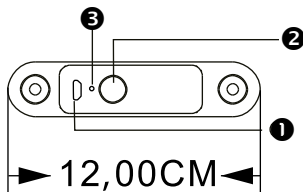
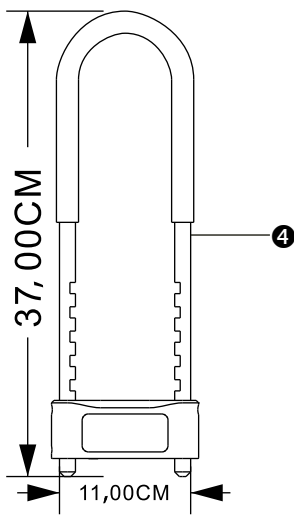

- 1 USB charging port
- 2 Fingerprint sensor
- 3 Indicator light
- 4 Lock shackle

The fingerprint bicycle lock is charged via a micro USB power cable*. Please charge it fully before using it for the first time.

A total of 20 fingerprints are supported: Numbers 1 & 2 are master fingerprints, the following numbers 3-20 are normal user fingerprints.

- The lock will be reset to the factory default mode and all fingerprints will be deleted as soon as one of the master fingerprints has been deleted.
- The lock can be unlocked by ANY fingerprint when it is in factory default mode.
- *Not contained in the scope of delivery*

| LED indicator light - general display | |
|---------------------------------------|-------------------------------------|
| Red light flashes → | Low battery charge |
| Red light is on continuously → | Please charge |
| Light off → | Fully charged |
| Indicator light in memory mode | |
| Green light flashes → | Registration mode / open |
| Green light is on continuously → | A fingerprint is saved successfully |
| Blue light is on continuously → | Master fingerprint is authorised |
| Blue light flashes → | Open (factory default mode) |
| Red light is on continuously → | Deletion mode for fingerprints |
| Red light flashes → | Saving of a fingerprint failed |

Registration of the first master fingerprint:



1. Open the lock (with any fingerprint). Press and hold the fingerprint sensor with one of your fingers for 8 seconds until the blue light is on continuously.

2. Then touch the sensor with the finger whose details need be stored - the green light flashes

3. Touch the sensor 4 times with different areas of the same finger.

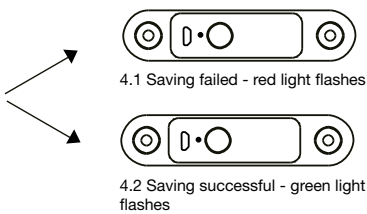

5. After executing the saving process five times, the first registration of the master fingerprint is successful (two master fingerprints are supported).

Registration of new fingerprints:



1. A master fingerprint is required for the registration of new fingerprints

2. Press and hold the sensor with your master fingerprint for 5 seconds until the blue light is on continuously

3. Touch the sensor with the finger whose details need be stored - the green light flashes

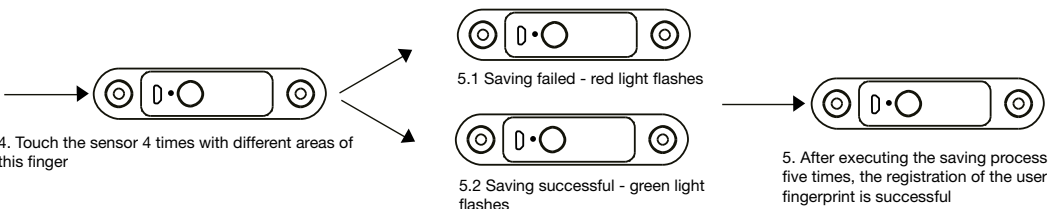

4. Touch the sensor 4 times with different areas of this finger

5. After executing the saving process five times, the registration of the user fingerprint is successful

Deleting all fingerprints & resetting to factory default mode

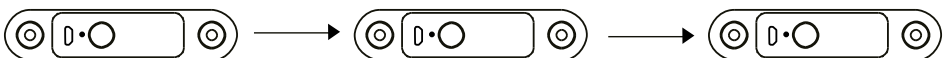

1. A master fingerprint is required to delete the fingerprints

2. Press and hold the sensor with your master fingerprint for 8 seconds until the red light is on continuously

3. Touch the sensor with the same master fingerprint - the green light is on continuously



4. All fingerprints are deleted and the lock is reset to factory default mode

Order no.: 6990-0307



4 026434 178487

BASI GmbH | Konstantinstraße 387
41238 Mönchengladbach | Germany
www.basi.eu

