

ASSA ABLOY Code Handle Door

Electromechanical code handle for doors



Application

For easy and convenient locking/unlocking of interior door.
E.g. Office doors, staffrooms, archives, back office, store applications.

Features

- "Access Filtering"
- Easy locking without keys
- No wiring
- Master code and up to 9 user codes.
- Blocking function if wrong code is entered five times
- Auto or manual locking
- "Simplicity creates security"

Function

- Indoor use only
- Fits lock cases with DIN, ANSI and other relevant standards
- Two CR2, 3V lithium batteries tested , (for approx 60 000 operations)
- 4-6 digit code
- Material: brushed stainless steel and satin chrome zinc
- Indication for battery change
- Tested to at least 100 000 operations, according to EN 1906
- Fire tested according to EN 1363

ASSA[®]

ASSA ABLOY

ASSA ABLOY Code Handle Door

Electromechanical code handle for doors

8812 for European DIN standard
 8810 and 8811 for Scandinavian standard
 8814 for ABLOY lock cases
 8815 for Japan
 8816 for ANSI Standard North America
 8818 For Spain (8812 rose with 45°)
 Also available in Long Plate versions.

Model example 8812

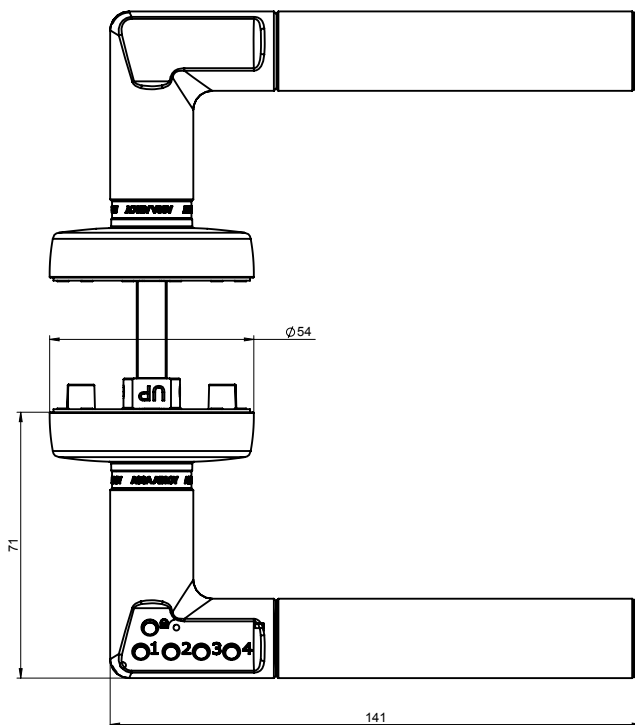

Distance ring 8820(accessory)

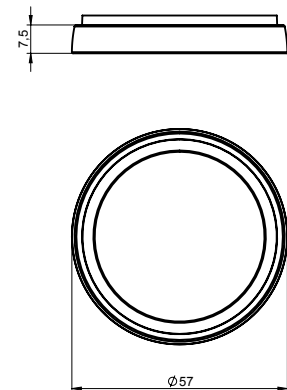

ASSA®

ASSA ABLOY

ASSA ABLOY, the global leader in door opening solutions, dedicated to satisfying end-user needs for security, safety and convenience

ASSA OEM AB
 P.O. Box 12199
 SE-402 42 Göteborg
 Sweden

phone +46 (0)31 704 40 00

info.gbg@assaoem.se
 www.assaoem.se

For drawings of 8810, 8814, 8815, 8816, 8817 and 8818, please see our homepage www.assaoem.se.

Number	Description	Adopted for locks	Non coded model
8812-7	Code Handle	DIN Standard 7mm sprint (FR)	8802-7
8812-8	Code Handle	DIN Standard 8mm sprint (EU)	8802-8
8814	Code Handle	ABLOY lock cases (9456 etc.)	8804
8815	Code Handle	JAPAN	
8816	Code Handle	ANSI version for North America (8mm spindle)	8806
8818	Code Handle	Same as 8812 but turned rose 45°	
8810	Code Handle	Scandinavia Modul, Evo, Connect	8801
8811	Code Handle	Scandinavian residential 2014	8803
8820	Distance ring		
8821	Battery hatch incl. spring		

All variants is supplied in right or left handle version.
 Also in Long Plate Versions, see separate leaflet.