

ASSA Connect 400 series-50

Lock case



Fallhakregellås
ASSA Connect 410



Hakregellås
ASSA Connect 411

Area of use 410

Lock case for entrance doors, archives, storehouses, offices, industries etc.

Attributes 410

- Mandrel depth 50 mm.
- Meets the requirements according to Swedish standard SS3522 issue 4 class 3 TR 29.
- Is included in by insurance companies approved locks.
- Hardened and guided motion hook bolt, strengthened deadlocking.
- Hook bolt provides a coupling connection between door and frame.
- Reversible latch bolt for alternate door hanging.
- Latch bolt in steel for fire-classified doors.
- Can be obtained with a built-in micro switch.
- CE certified.
- Is used with ASSA Security striking plate 1487-1/5 or 1489-11, 12.
- Is delivered with a drill protection.

Function 410

- Hook bolt is locked in and out with key or magnetic thumb turn cylinder 13 round.
- Latch bolt is pulled in with lever handle.
- 400-series is developed to pass the highest security

requirements where the double round cylinders of ASSA are a part of the specification.

Area of use 411

Lock cases for entrance doors, sliding doors and swing doors provided with pull handle/push plate.

Attributes 411

- Mandrel depth 50 mm.
- Meets the requirements according to Swedish standard SS3522 issue 4 class 3 TR 29.
- Is included in by insurance companies approved locks.
- Hardened and guided motion hook bolt.
- Strengthened deadlock.
- Hook bolt provides a coupling connection between door and frame.
- Can be obtained with a built-in micro switch.
- Is used with ASSA Security striking plate 1487-1/5 or 1489-11, 12.
- Is delivered with a drill protection.

Function 411

- Hook bolt is locked in and out with key or magnetic thumb turn cylinder 13 round.
- 400-series is developed to pass the highest security requirements where the double round cylinders of ASSA are a part of the specification.

ASSA[®]
ASSA ABLOY

ASSA ABLOY, the global leader
in door opening solutions.

ASSA Connect 400 series-50

Lock case

Entrance- and perimeter

Lock sets for entrance-, perimeter- and other important doors. Meets the demands according to Swedish standard SS3522 issue 4 class 3 TR 29. Is included in by insurance companies approved locks.

Environment

The product is developed to have a minimal impact on the environment during its life-cycle. The product is recycled as scrap-metal, eventual micro-switch is separated and recycled as electronic waste.

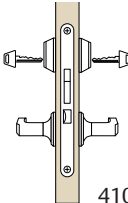
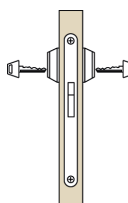
Lock set	Area of use	Function cylinder side		Function inside
ASSA 410-50	Lock sets for entrance doors, archives, storehouses, offices, industries etc.	The 360° key movement lifts the deadlock and locks the hook bolt in or out of the lock case. The lever handle pulls in the latch bolt.		The 360° key movement lifts the deadlock and locks the hook bolt in or out of the lock case. The lever handle pulls in the latch bolt.
ASSA 411-50	Lock sets for entrance doors, sliding doors and swing doors provided with pull handle/push plate.	The 360° key movement lifts the deadlock and locks the hook bolt in or out of the lock case.		The 360° key movement lifts the deadlock and locks the hook bolt in or out of the lock case.

ASSA®

ASSA ABLOY

ASSA ABLOY, the global leader in door opening solutions, dedicated to satisfying end-user needs for security, safety and convenience.

ASSA OEM AB
P.O. Box 371
SE-631 05 Eskilstuna
Sweden

phone +46 (0)16 17 70 00
fax +46 (0)16 17 70 49

Customer support:
phone intl. +46 (0)16 17 71 00
phone nat. 0771-640 640
fax +46 (0)16 17 73 72
e-mail: helpdesk@assa.se

www.assaoem.se

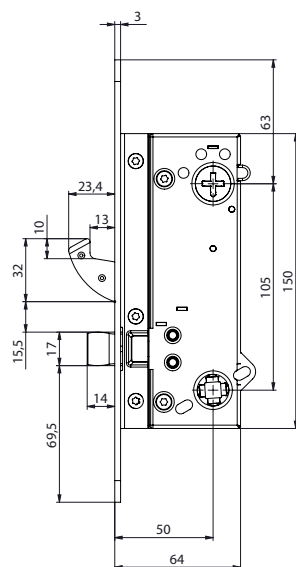

Måttitning,
Connect 410-50

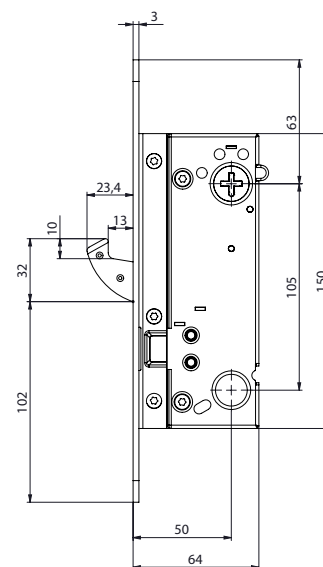
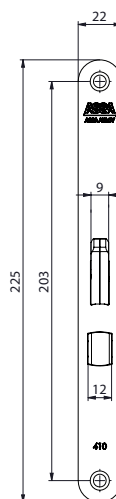

Måttitning,
Connect 411-50

